

Order No. R800 8102 00



The Backtrack™ is a stereo audio switcher designed for bands using redundant playback devices on stage. The primary and backup playback devices are both connected to the Backtrack using dual ¼" TRS connectors or stereo 3.5mm inputs, with XLR outputs feeding the PA system. Should the primary playback device fail, an input select switch on the front of the Backtrack allows you to quickly switch to your backup device to ensure your live performance is unaffected. A JR-2™ remote footswitch can be connected, giving you the ability to switch inputs or mute from anywhere on stage. The Backtrack also includes a headphone section with a dedicated level control and a cue select switch, so you can check each playback device silently without affecting the send to the PA. With the Backtrack in your setup, the show will always go on.

**Features**

- Dual ¼" TRS and Stereo 3.5mm inputs
- Transformer isolated XLR outputs for the PA
- ¼" TRS monitor outputs to feed powered speakers
- Headphone output with level control

**Applications**

- Switch between redundant playback devices on stage
- Seamlessly select backup device should primary playback fail
- Headphones can monitor each source silently for testing

**Extras**

- JR-2 input allows remote footswitch control
- Ground lift to eliminate buzz and hum
- Link ¼" output to connect multiple Backtracks
- Can be rack-mounted with SA series rack adaptor

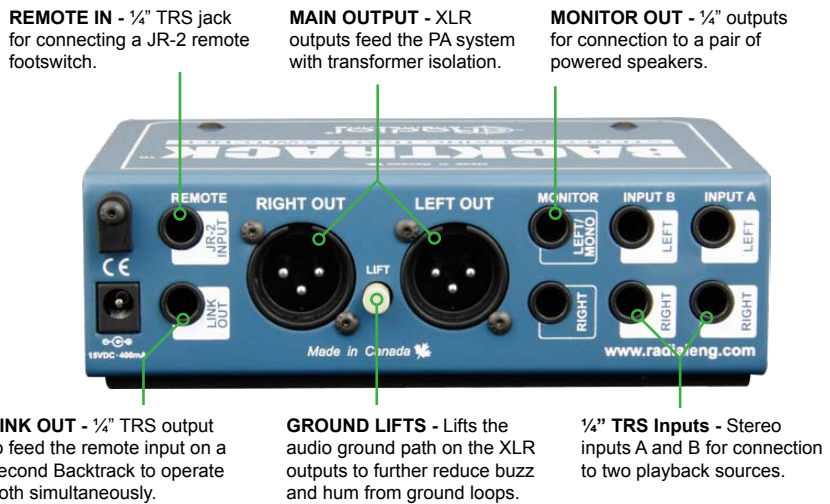
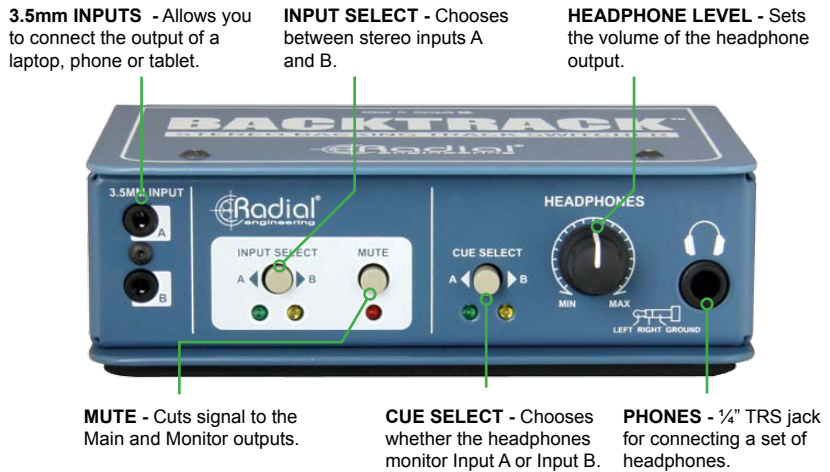

**Switch backing track sources remotely**  
Use the JR-2 footswitch to mute or switch between playback sources. Monitor on stage with a powered speaker while simultaneously sending signal to the house PA system.

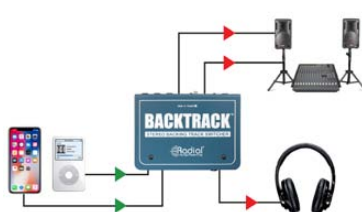

**Use the headphone output to cue up tracks**  
The headphone output can listen to either input without switching the feed to the PA, allowing you to cue the next track and monitor silently on headphones.

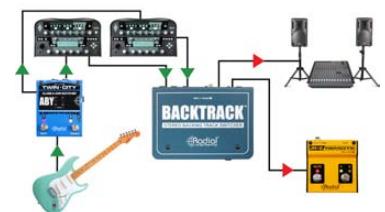

**Switch between amp modeling systems**  
Take the balanced or unbalanced line-level outputs of two stereo amp modeling devices into the Backtrack; it will automatically balance the signal at the XLR outputs to the PA. Should one amp simulator go down, use the JR-2 to easily switch to the backup unit.