

SSW-3

Dual 10" (250mm) Passive In-Wall Subwoofer

JBL

SYNTHESIS[®]
HARMAN



Features

- Dual 10" (250mm) composite cone woofers
- Designed for use with JBL Synthesis SDA amplifiers
- Self-contained, concealed module with integrated back box
- SSW-3 includes back box and baffle shipped together in over-packed box
- Zero-bezel, magnetically attached grille
- Rigid MDF enclosure
- Designed to fit standard 2 x 6 stud frame construction

*Connect up to 4 JBL SSW-3 units to an SDA-4600 amplifier

Specifications

- ▶ Frequency Response: 20Hz – 150Hz (-6dB)
- ▶ Maximum Recommended Amplifier Power: 600 Watts RMS
- ▶ Impedance: 4 Ohms nominal
- ▶ Sensitivity: 88dB (2.83V/1m), both woofers driven
- ▶ Woofer: Dual 10"/250mm composite cone woofers
- ▶ Dimensions of SSW-3BB enclosure (H x W x D): 64" x 14" x 5.1" (1626mm x 356mm x 130mm)
- ▶ Mounting Cutout Size (W x H): 15.5" x 66" (393.7mm x 1676.4mm)
- ▶ Grille Size (W x H x D): 16.890" x 28.425" x 0.375" (429mm x 722mm x 9.53mm)
- ▶ Weight per Speaker: 81 lbs (36.75kg)

SSW-3

Dual 10" (250mm) Passive In-Wall Subwoofer

JBL

SYNTHESIS[®]
HARMAN

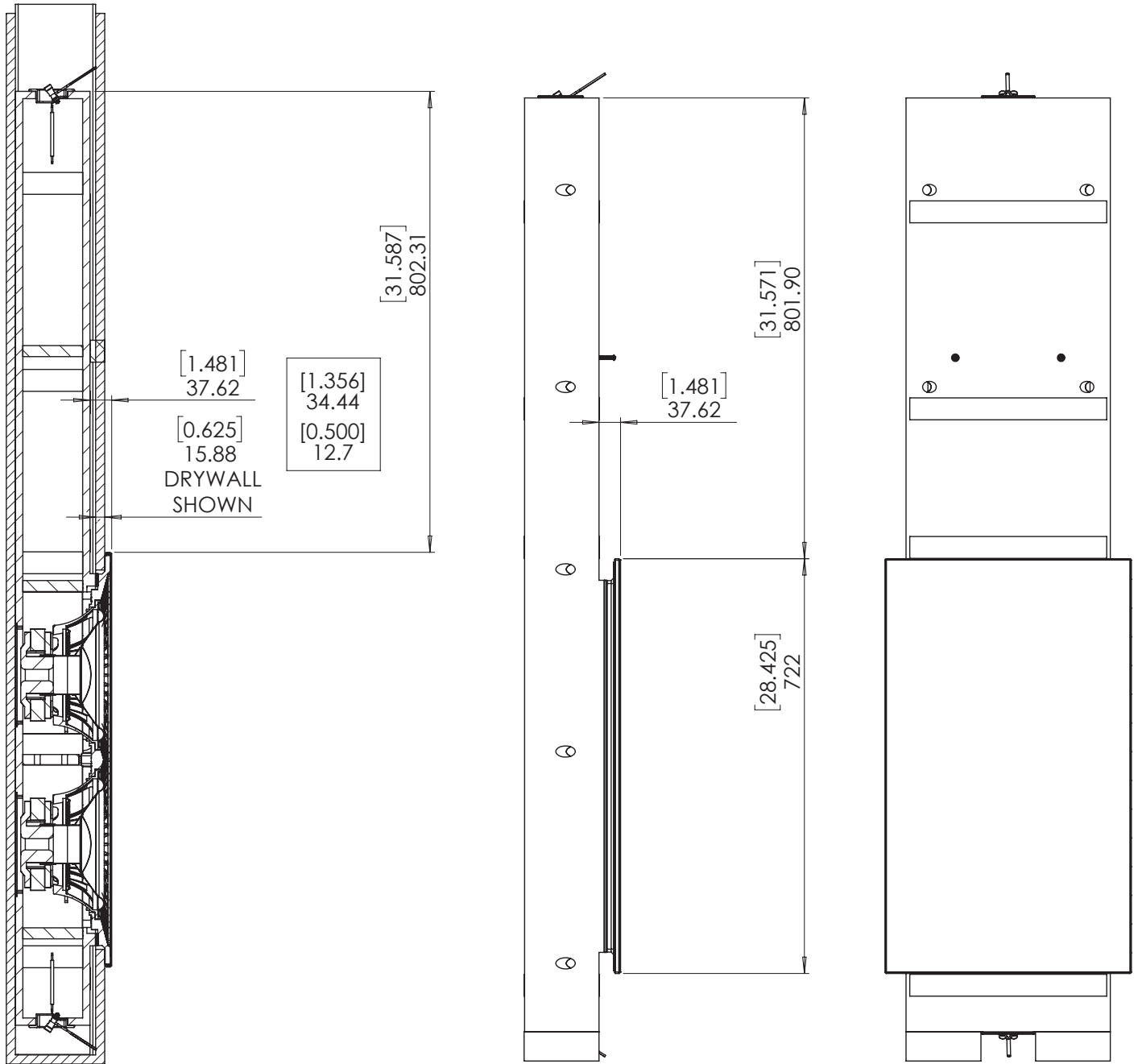

SECTION Y-Y

SCALE 1 : 8